

**INSTRUCTIONS FOR FILLING OUT:**

**CLACKAMAS COUNTY PUBLIC LAND CORNER RESTORATION REPORT**  
**TO BE PLACED ON 18" X 24" POLYESTER FILM W/STANDARD LAYOUT**

The purpose of this is to outline an optional method of supplying information to the public, when there is a change in condition of a monument but Record of Survey Map is not required to be filed. This report should be filled out as completely as possible. If no new monument or accessories are set please state that in the appropriate location.

The *original* document must be filed at the office of the County Surveyor. There is no charge to file this report with the Clackamas County Surveyor.

If you have any questions, please contact the office of the Clackamas County Surveyor at (503) 742-4475.

The following information is required:

- Section, township, range
- Previous restorations/surveys
- CGDB Corner designation
- Monument and accessories found (condition and source)
- Monument detail and sketch
- Monument or references set (procedures and description)
- New accessories
- Location and comments / Compass declination
- Basis of bearings
- Firm name/address/phone number/Party Chief/witness
- Seal and signature
- More than one corner may be reported on the same sheet.

**\*NOTE:** These instructions supersede any of the previous instructions.

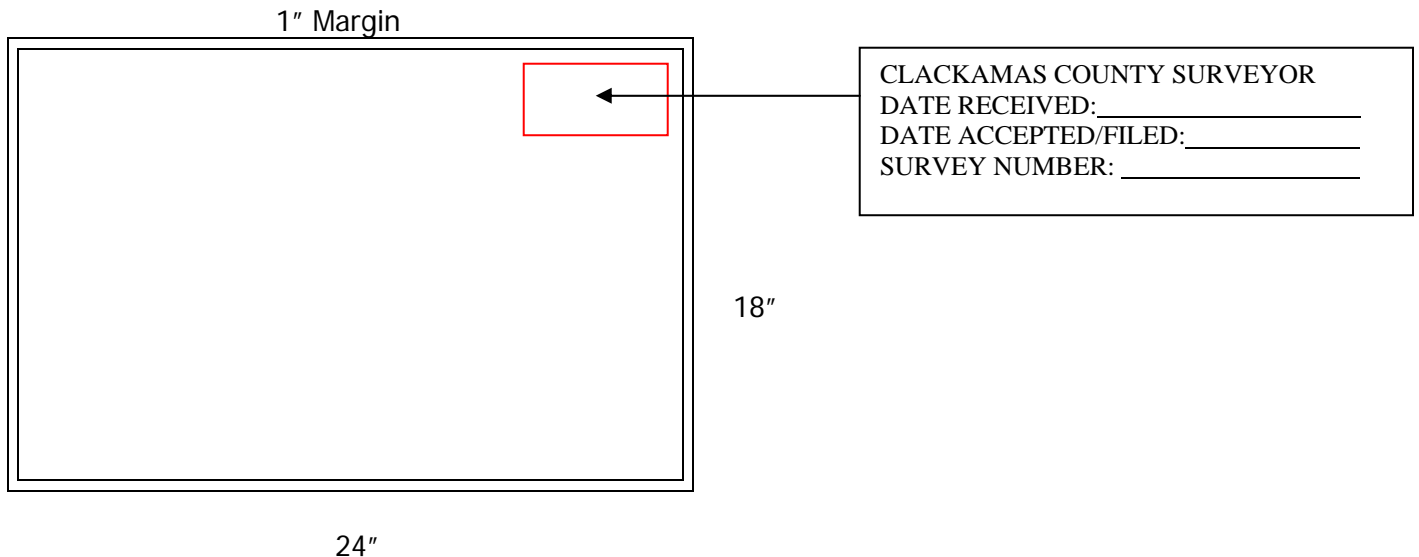

The report must meet current archival standards and be prepared on 18" x 24" polyester film. Current standards may be found at:

<http://www.co.clackamas.or.us/surveyor/surveyrecords.htm>

At that page, select "Standards for Records of Survey"